

Muskingum County, Ohio - Property Record Card  
Parcel: 62-78-03-15-000  
Card: 1

GENERAL PARCEL INFORMATION	
Owner	KITZMILLER LESA L & DANNY J WOLFE
Property Address	62 W GRANDVIEW AVE
Mailing Address	2700 NORTH A1A #1406 FORT PIERCE FL 34949
Land Use	511 - SINGLE FAMILY DWLG UNPLAT 0-09
Legal Description	R 13 TP 11 SEC 5 .26A

VALUATION		
	Appraised	Assessed
Land Value	\$15,400.00	\$5,390.00
Improvements Value	\$52,100.00	\$18,240.00
CAUV Value	\$0.00	\$0.00
Taxable Value	\$23,630.00	
Annual Tax (w/o delinquencies)	\$844.42	

LAND					
Land Type	Acreage	Depth	Frontage	Depth	Value
L1 - Front Lot Entry	0.264	100	115	0	15410

AGRICULTURAL				
Land Type	Land Usage	Soil Type	Acres	Value

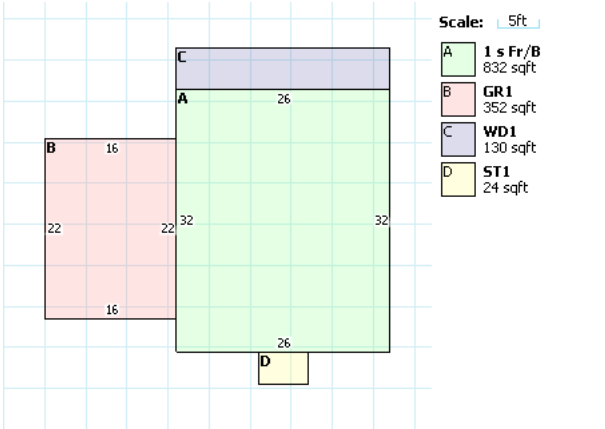

RESIDENTIAL			
Building Style	CONVENTIONAL	Full Baths	2
Year Built	1960	Half Baths	0
Stories	1	Basement	FULL BASEMENT
Finished Area	832	Finished Basement Area	0
First Floor Area	832	Heating	HEAT
Half Floor Area	0	Cooling	NONE
Upper Floor Area	0	Exterior Wall	FRWMAS
Rooms	5	Attic	NONE
Bedrooms	2	Number of Fireplace Openings	1
Family Rooms	0	Number of Fireplace Stacks	1

ADDITIONS			
Description	Area	Year Built	Value
ST1 - Stoop Masonry	24	0	\$1,010.00
GR1 - Garage Frame	352	0	\$7,370.00
WD1 - Wood Deck	130	0	\$2,010.00

IMPROVEMENTS
--------------

SALES			
Date	Buyer	Seller	Price
7/2/2004	KITZMILLER LESA L &	WOLFE MARY LOU	0
4/29/2004	WOLFE MARY LOU	WOLFE JOSEPH W &	0
1/1/1990	WOLFE JOSEPH W &	Unknown	0

COMMERCIAL
------------

